

Top View

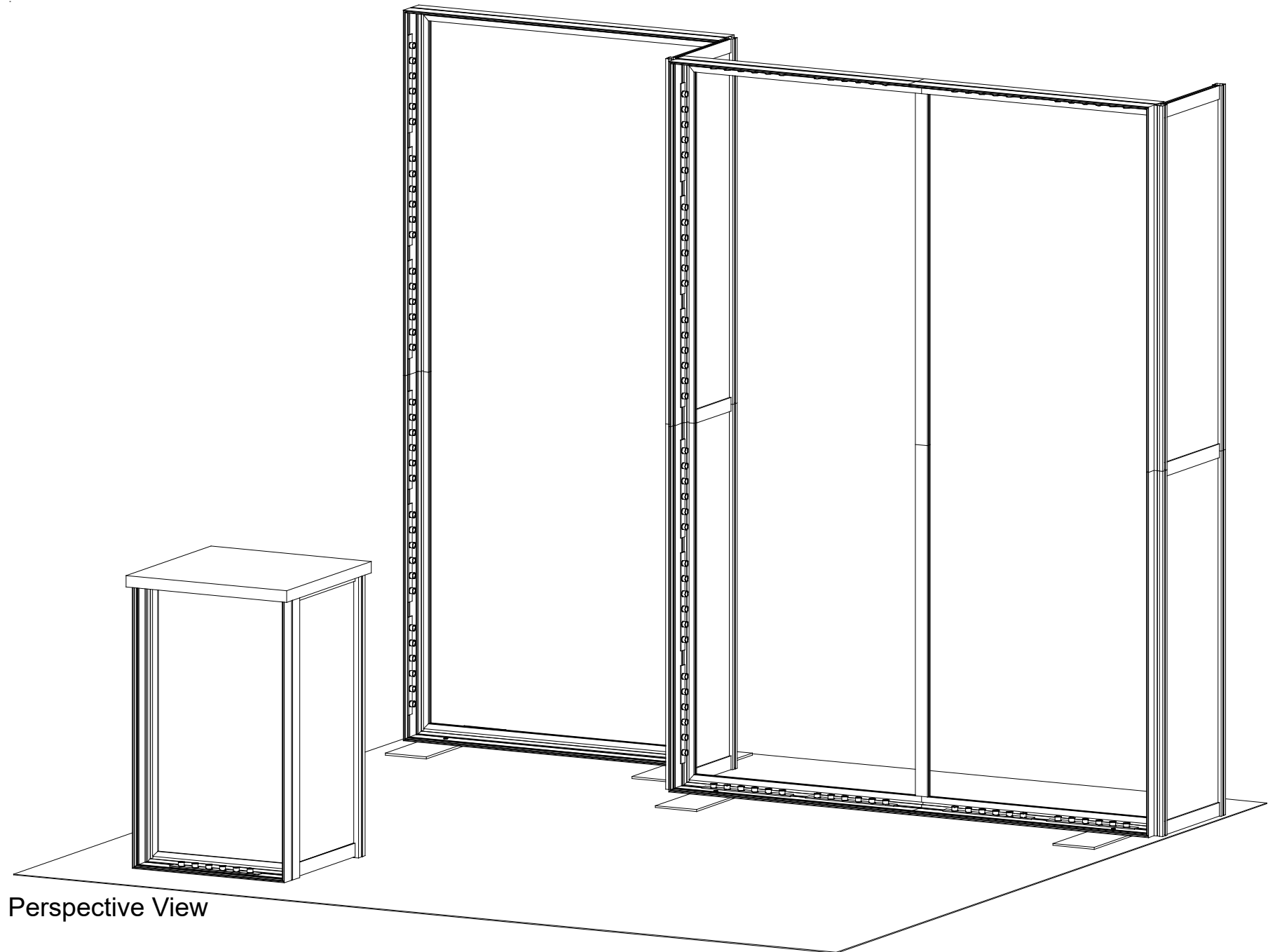

Perspective View

General Setup Instructions

- Read entire setup instruction manual prior to unpacking parts and pieces.
- The setup instructions are created specifically for this configuration.
- Setup instructions are laid out sequentially in steps, including exploded views with detailed explanation for assembly.

Cleaning & Packing

- For Cleaning Metal, Plex, & Laminate Parts: Use a **MILD NON-ABRASIVE** cleanser and soft cloth/paper towel to clean all surfaces.
- Keep exhibit components away from heat and prolonged sun exposure. **Heat and UV exposure will warp and fade components.**
- Retain all provided Packing Materials. All provided packing materials are for ease of repacking & component protection.

Disassembly

- For loss prevention, tighten all set screws and locks during disassembly.

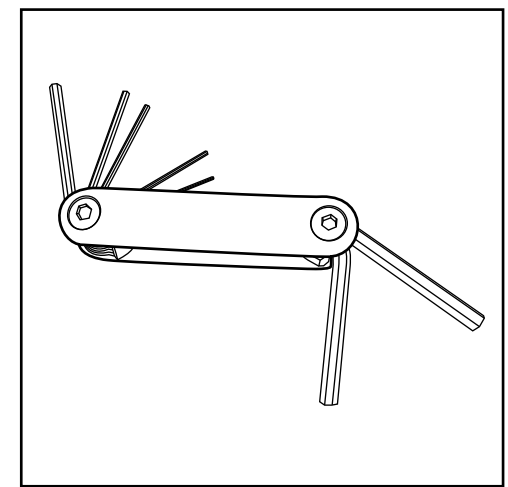

Hex Tool - Essential for Assembly

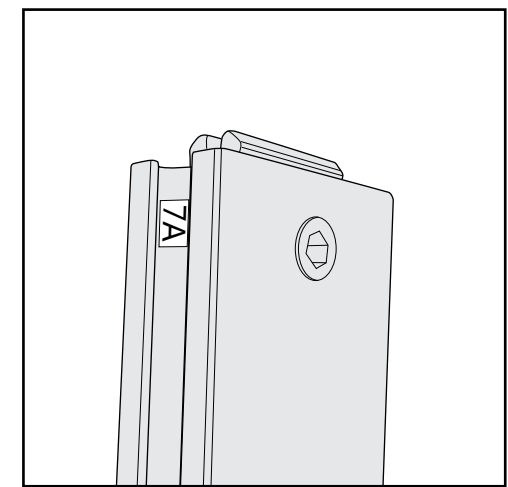

Part Identification - Numbering

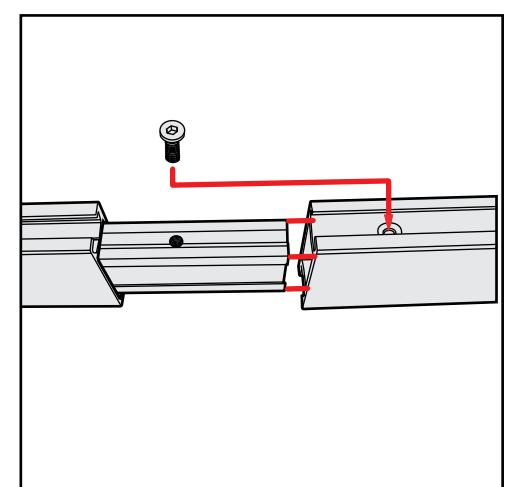

Spline Connection

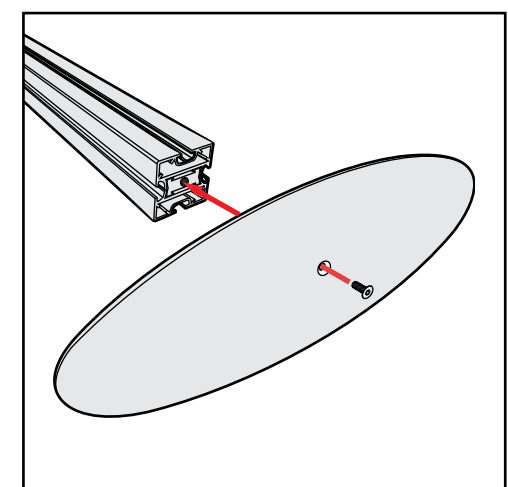

Base Plate & Extrusion Connection

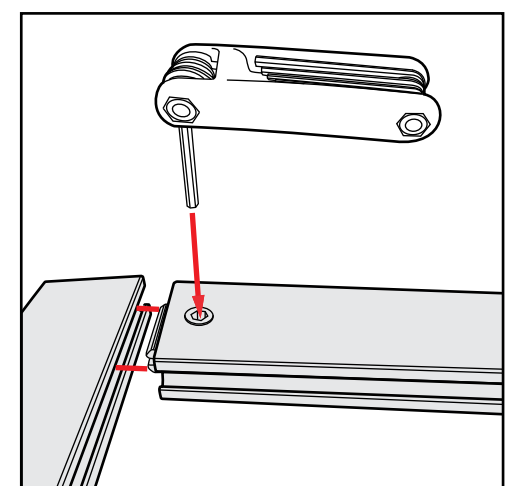

Extrusion & Lock Connection

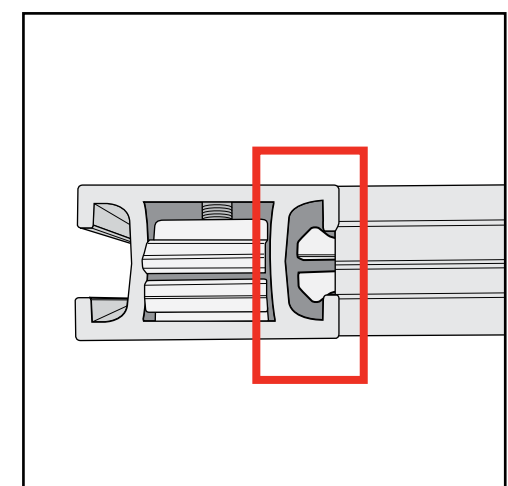

Engaged Lock

 **WARNING**

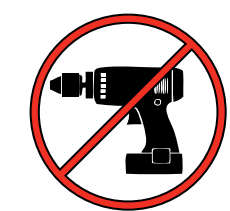

DO NOT USE POWER TOOLS

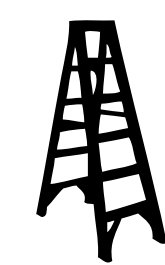

LADDERS OR LIFTS MAY BE REQUIRED



ALL CONNECTIONS MUST BE TIGHTLY SECURED

- 1) Locate channels along the edges of extrusions
- 2) Insert graphic corners first into channels then center point of graphic into channels. Allows for proportional fit around the perimeter of the extrusion.
- 3) Working from center to corner, slide silicon edge on graphic into channel.
- 4) After all edges of graphic have been inserted into channels, step back and assess graphic fit, make adjustments where needed.

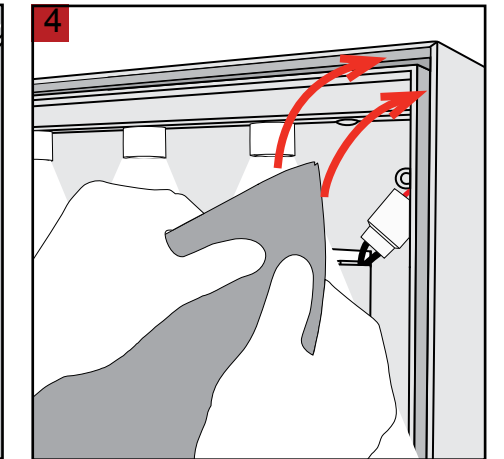
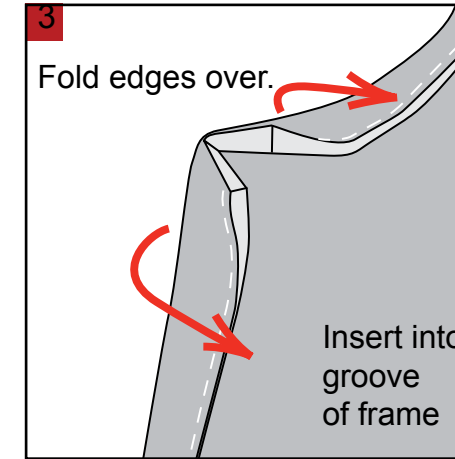
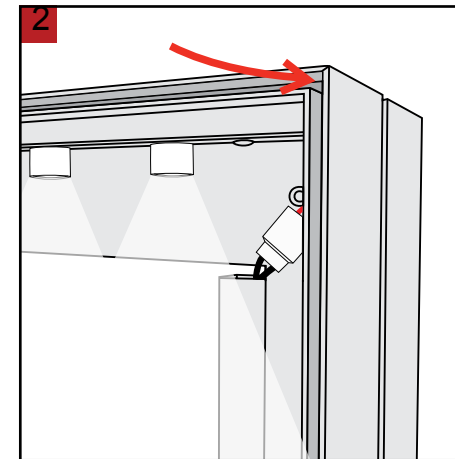
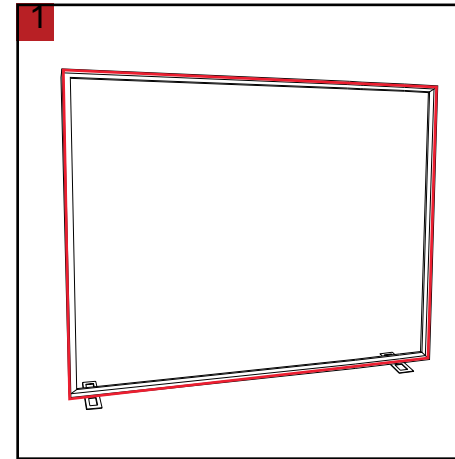

Straight Connection

When assembling frame, first attach all **straight connectors**, then attach **corner connectors**.

- 1) Place extrusions end-to-end.
- 2) Loosen all knobs, then slide **straight connectors** across the seam of extrusions.
- 3) Tighten all knobs to secure connection.

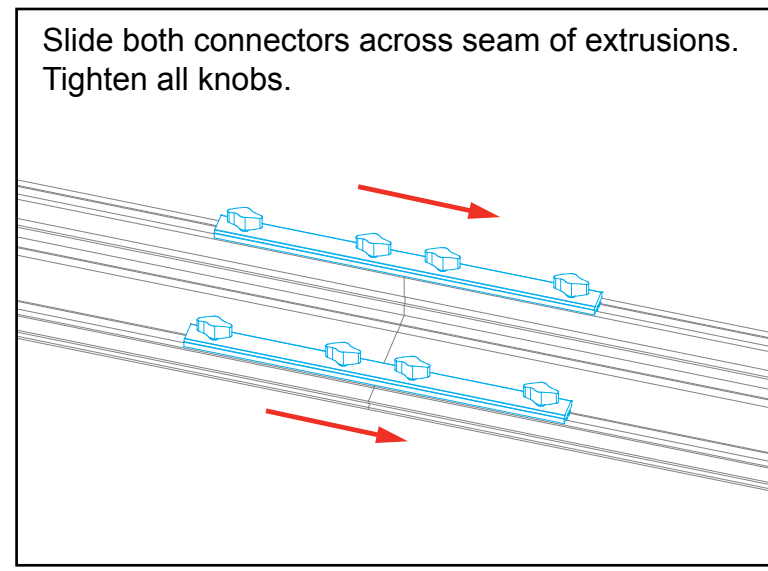
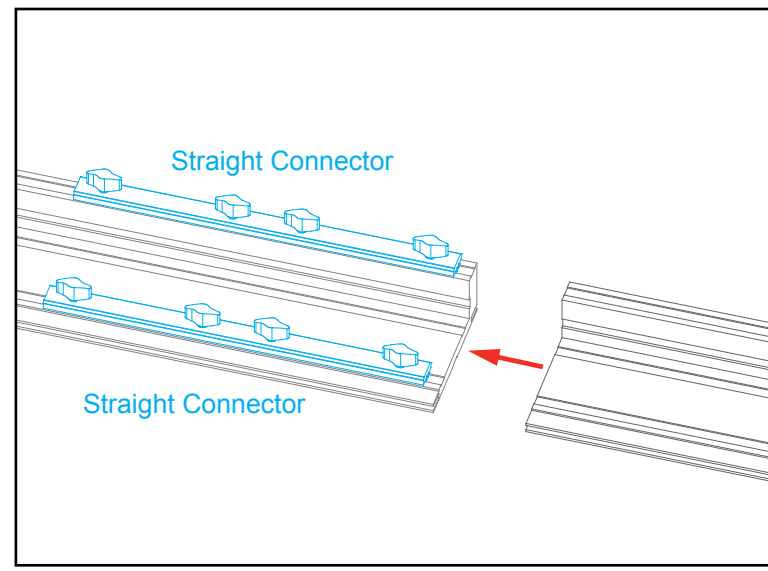

All knobs must be tightened securely to ensure a proper connection.

Disassembly

- 1) Loosen all knobs.
- 2) Slide connectors off of one extrusion.
- 3) Tighten knobs to prevent loss during packing & shipping.

Keep straight connectors in groove of extrusion. Do not remove connectors during disassembly.

Corner Connection

- 1) Loosen knobs, then slide vertical extrusions onto **corner connectors** of **lower** horizontal extrusion.
- 2) Slide **corner connectors** of **upper** horizontal extrusion into grooves of vertical extrusions.
- 3) Tighten all knobs to secure connection.

Disassembly

- 1) Loosen knobs on vertical extrusions.
- 2) Slide the vertical extrusions off of **corner connectors** on lower and upper horizontal extrusions.

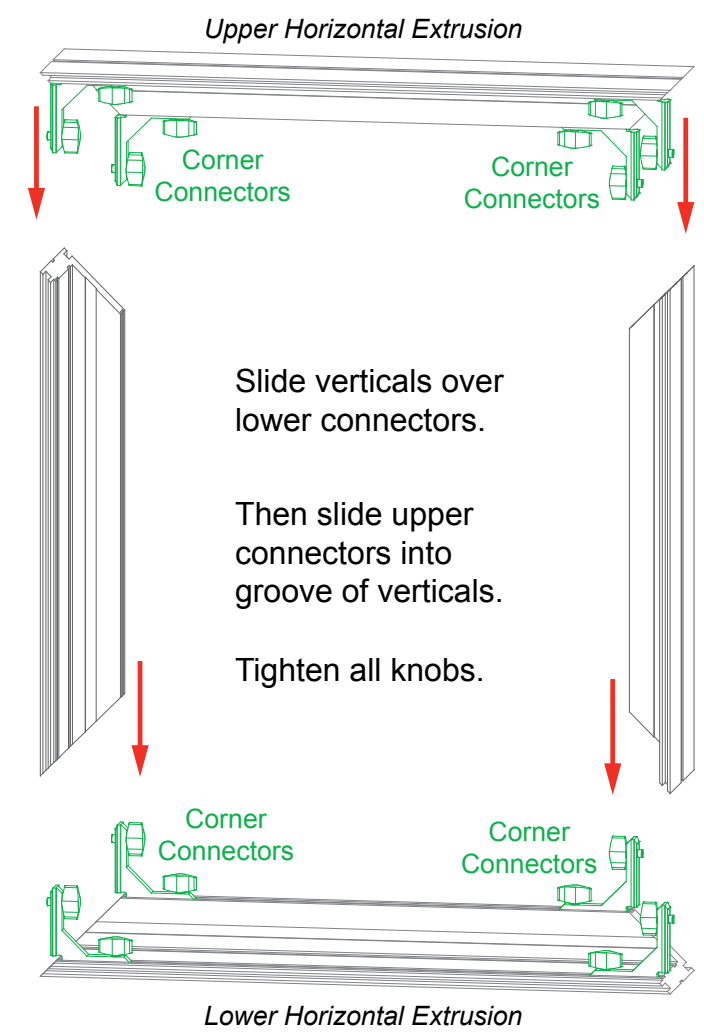

Adjust connectors if necessary to prevent gaps in connection.

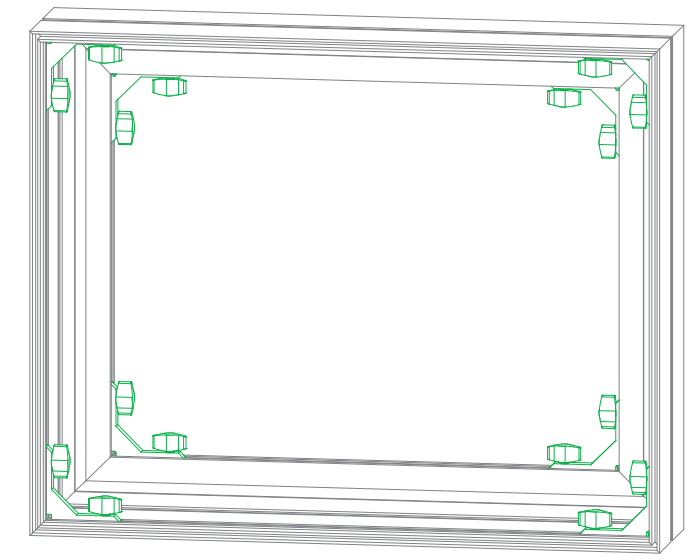

COMPLETED ASSEMBLY

All knobs must be tightened securely to ensure a proper connection.

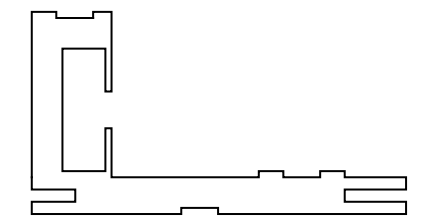

CEI110 Profile

Top View of Each Level

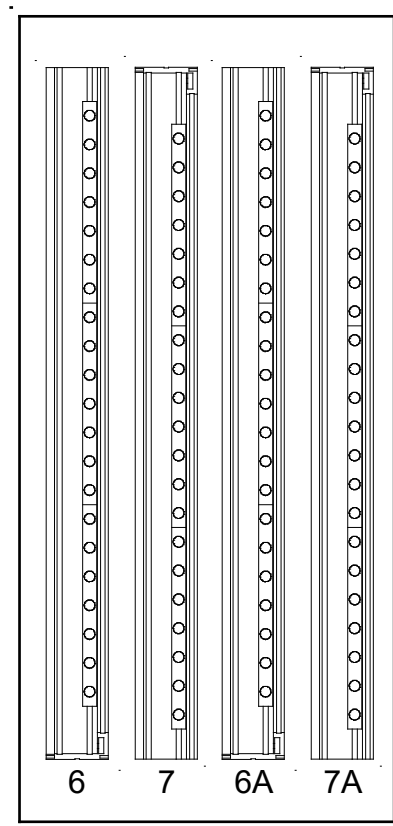

Level 1 (Bottom Level)

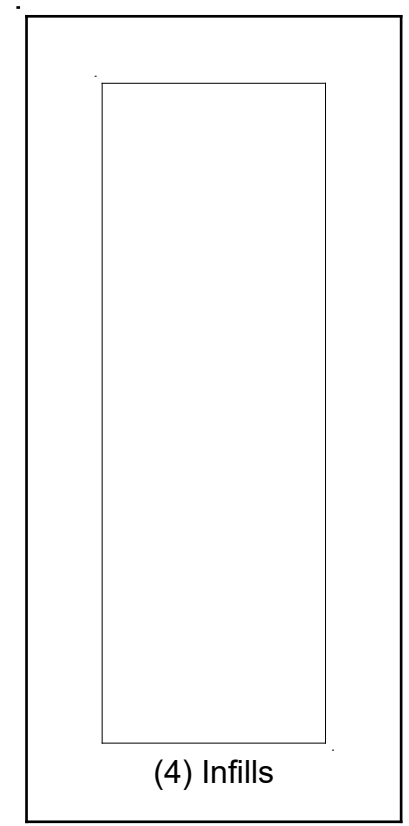

Level 2

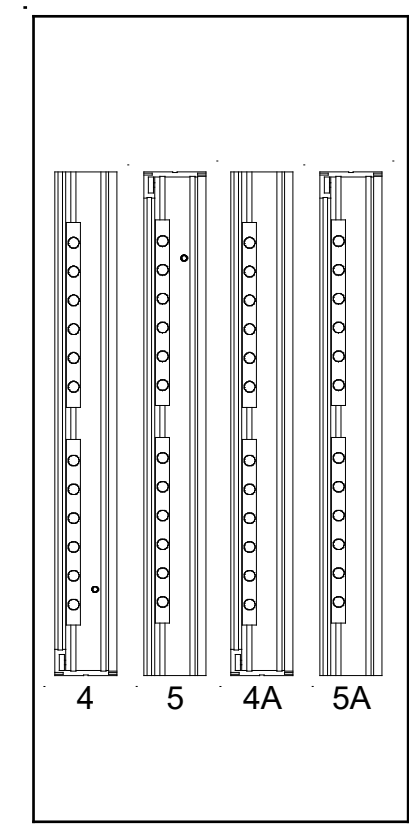

Level 3

Lights

Graphics

Setup Hardware

Top View of Each Level

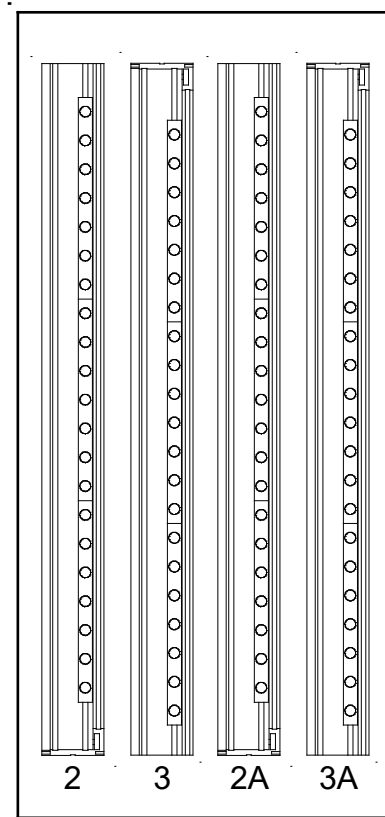

Level 1 (Bottom Level)

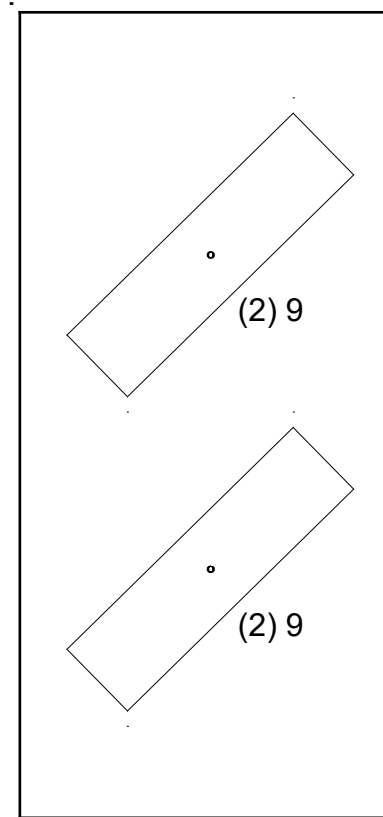

Level 2

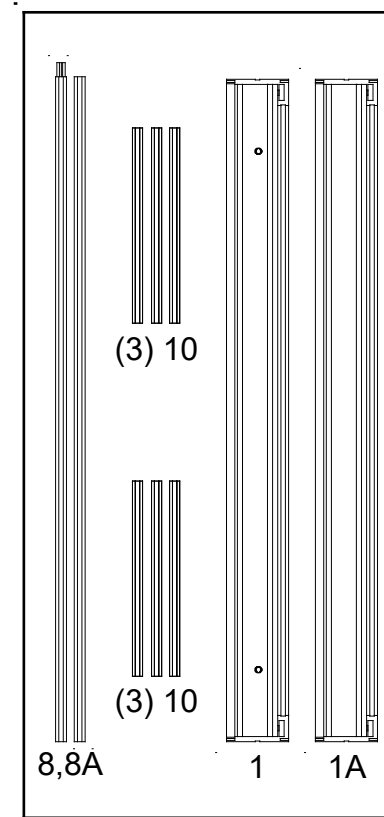

Level 3

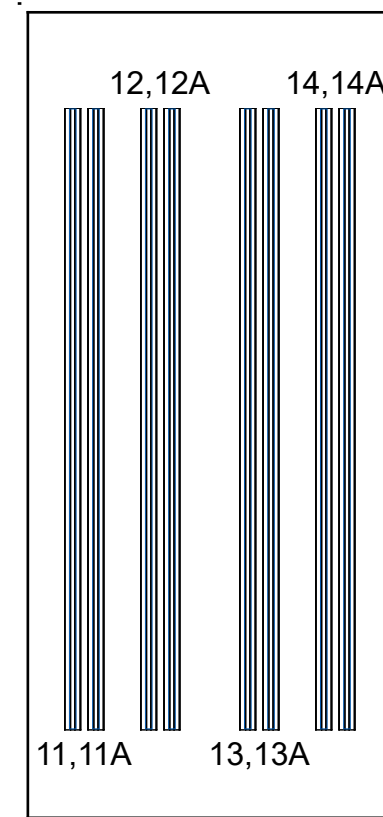

Level 4

Top View of Each Level

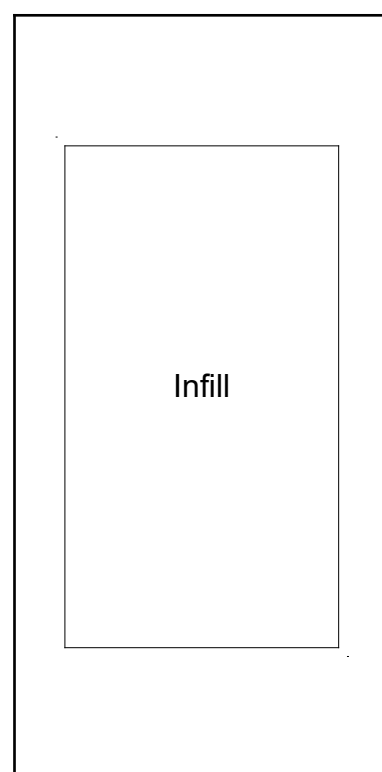

Level 1 (Bottom Level)

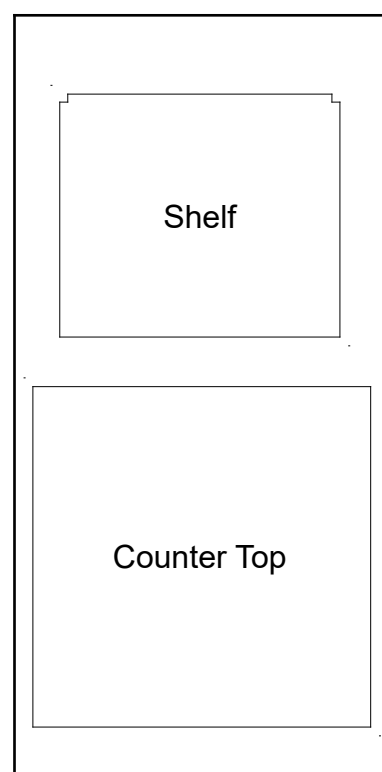

Level 2

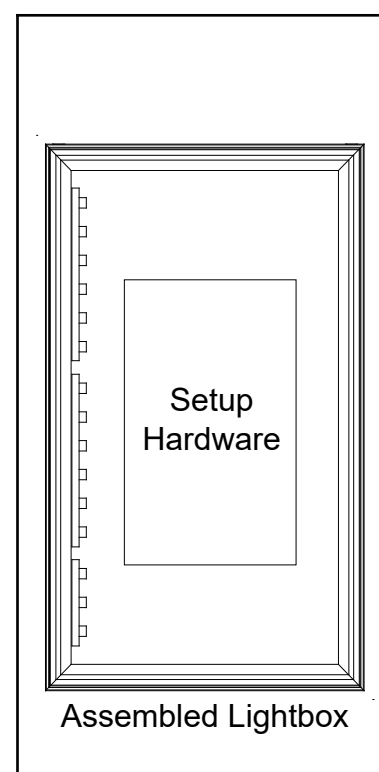

Level 3

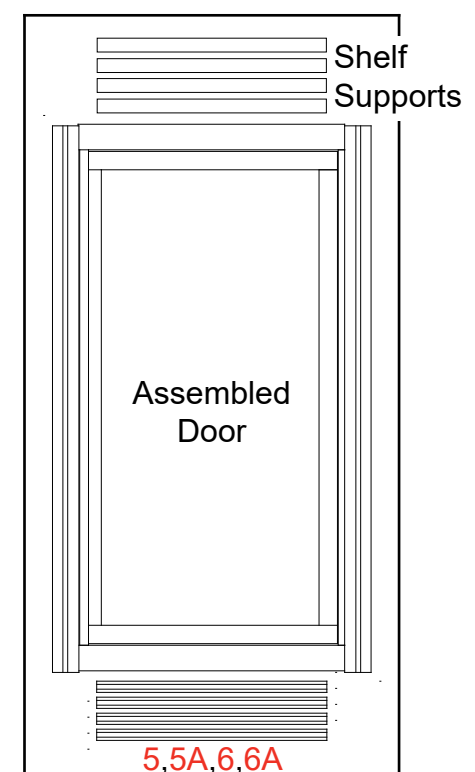

Level 4

Item	Qty.	Description
1,1A	1,1	46" CEI110 Horizontal Extrusion
2,2A	1,1	48" CEI110 Vertical Extrusion
3,3A	1,1	48" CEI110 Vertical Extrusion
4,4A	1,1	35" CEI110 Horizontal Extrusion
5,5A	1,1	35" CEI110 Horizontal Extrusion
6,6A	1,1	48" CEI110 Vertical Extrusion
7,7A	1,1	48" CEI110 Vertical Extrusion
8,8A	2	46.1767" Z45 Vertical Extrusion
9	4	Base Plate
--	1	8" PR53 Connector

Steps:

- 1) Assemble CEI110 extrusions, flat on floor, as shown. See CEI110 Frame Assembly sheet for instruction.
- 2) Connect verticals [8] together. See [Z45 Straight Connection](#) detail.
- 3) Attach [8/8] into center of assembled lightbox, as shown. See [Z45 Attachment](#) detail.
- 4) Attach base plates [9] to horizontals [1] [4] and [5], using bolts, washers, and wing nuts, then lift assembled lightboxes upright.

Keep PR53 connector attached to vertical [8], when packing.

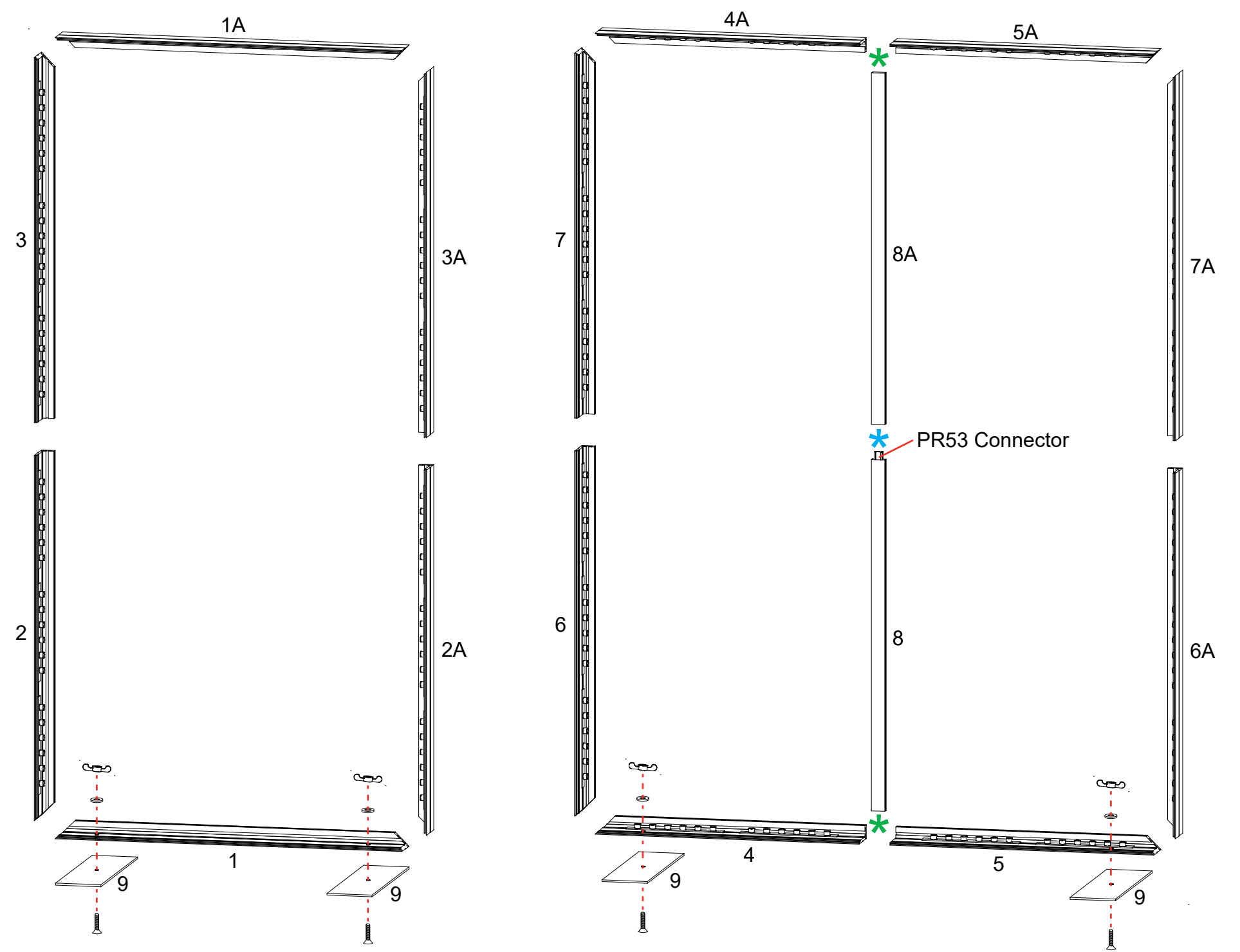
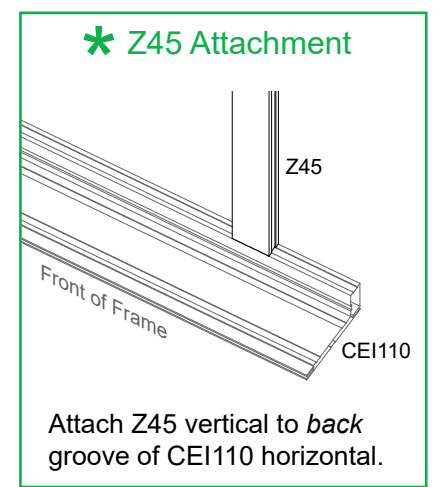
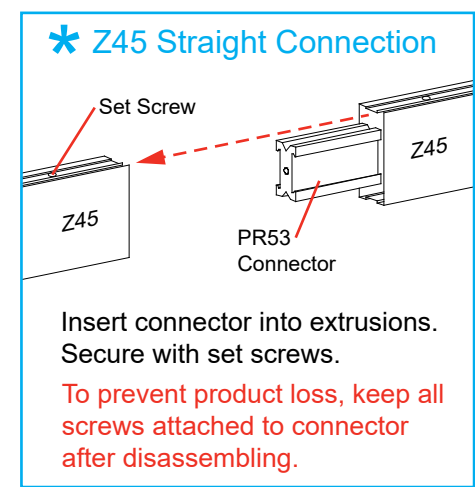

Item	Qty.	Description
10,10A	1,1	15" Z45 Horizontal Extrusion
11,11A	1,1	48" S40 Vertical Extrusion w/ PR53
12,12A	1,1	48" S40 Vertical Extrusion
13,13A	1,1	48" S40 Vertical Extrusion w/ PR53
14,14A	1,1	48" S40 Vertical Extrusion
--	6	48" V31 Connector

Steps:

- 1) Assemble S40 extrusions together, with **infills** and [10] between.
- 2) Attach left and right wall assemblies to lightbox assemblies, using connectors. See **V31 Connection** detail.

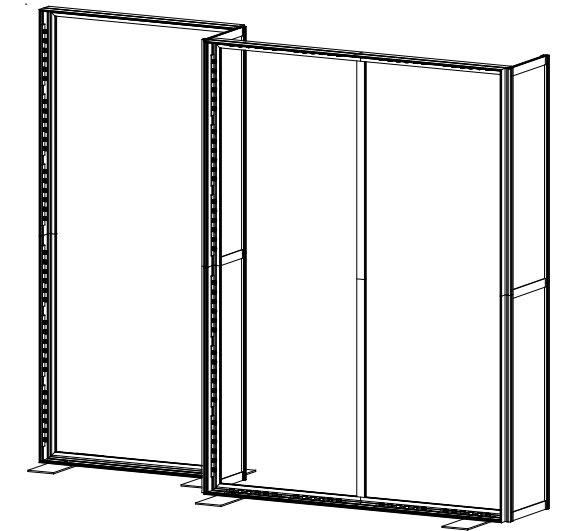

Completed Assembly

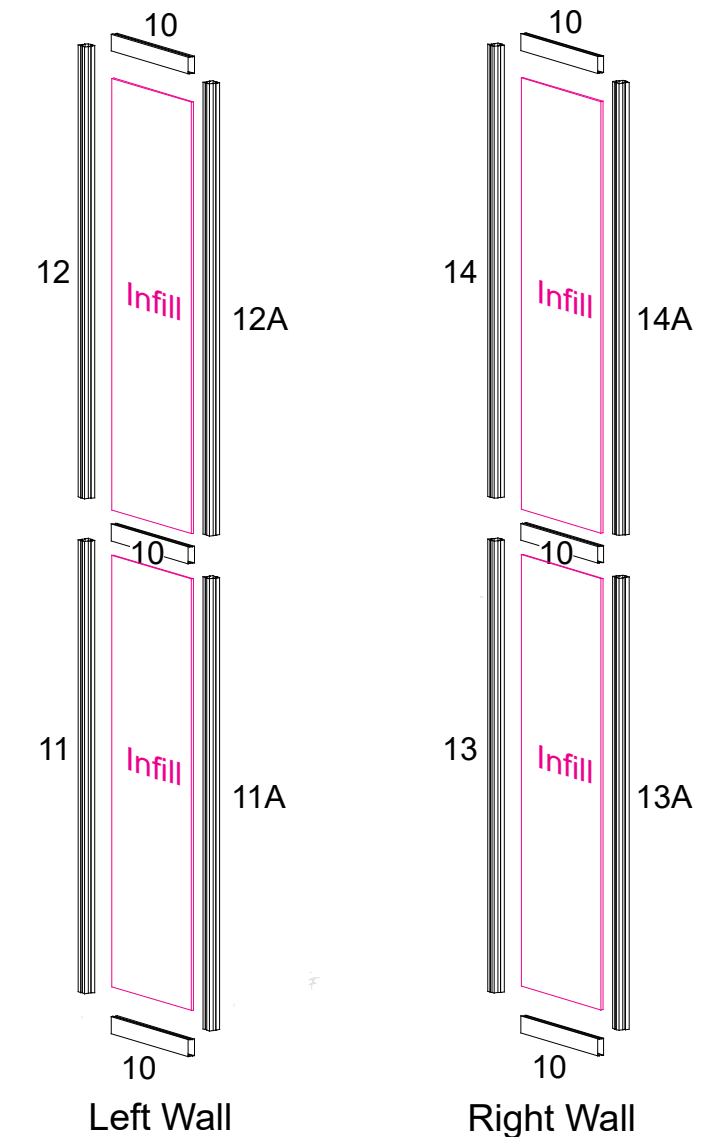
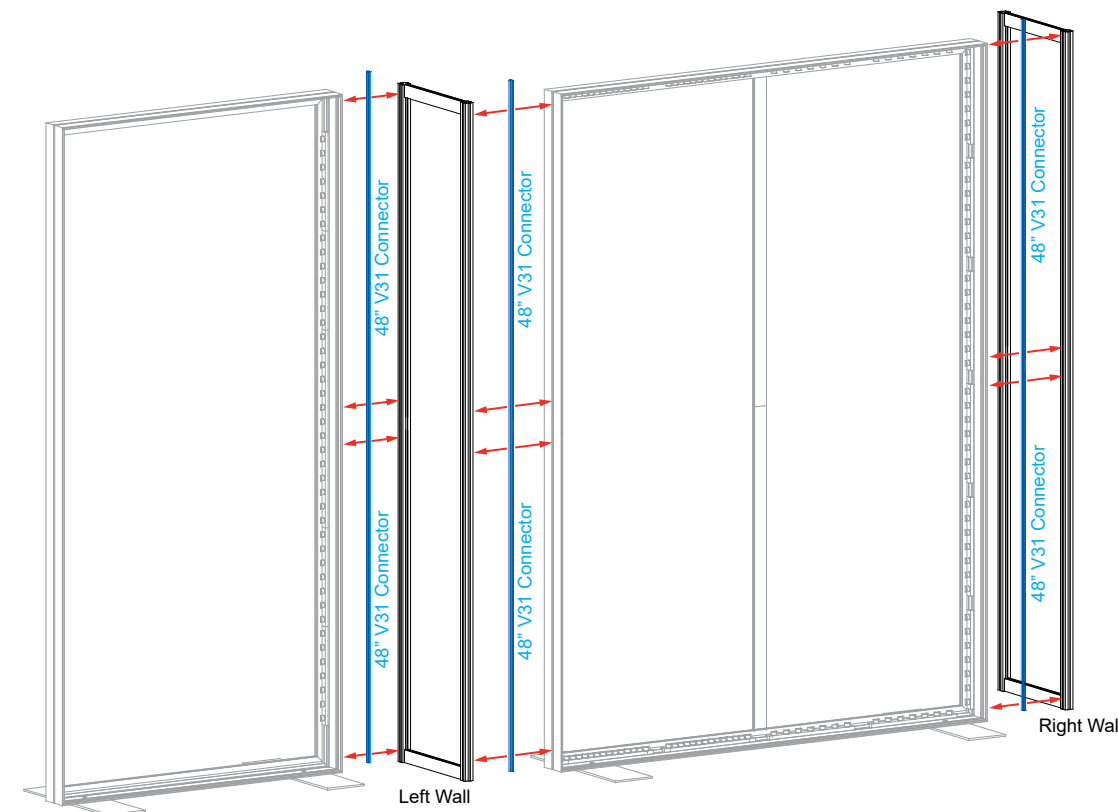
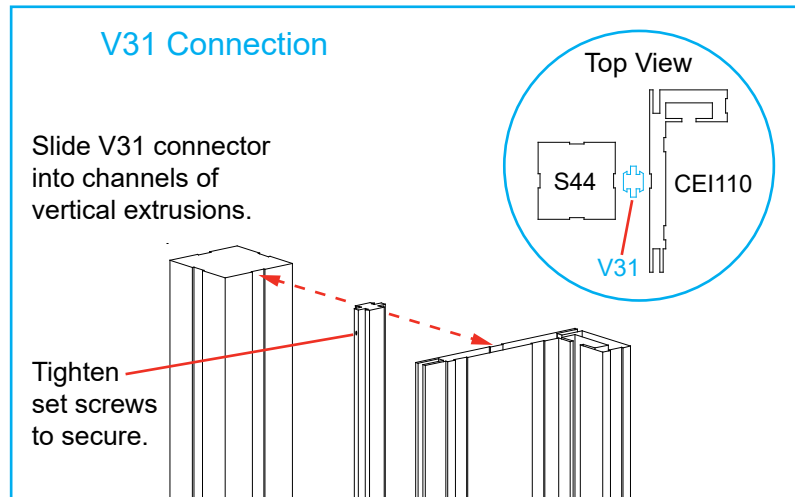
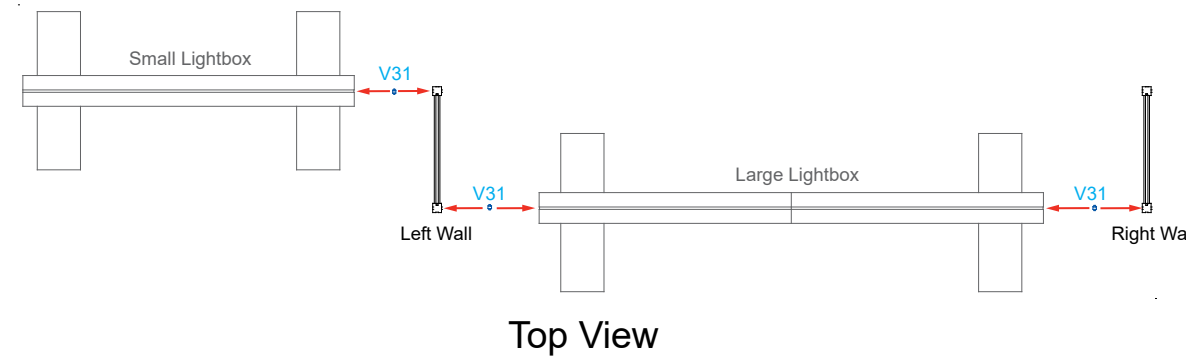

Steps:

- 1) Connect lighting power cords and attach transformers.
See [Light Connection](#) details.
- 2) Install SEG graphics to front of assembled lightboxes and blocker fabric to back. See SEG Installation sheet, for instruction.

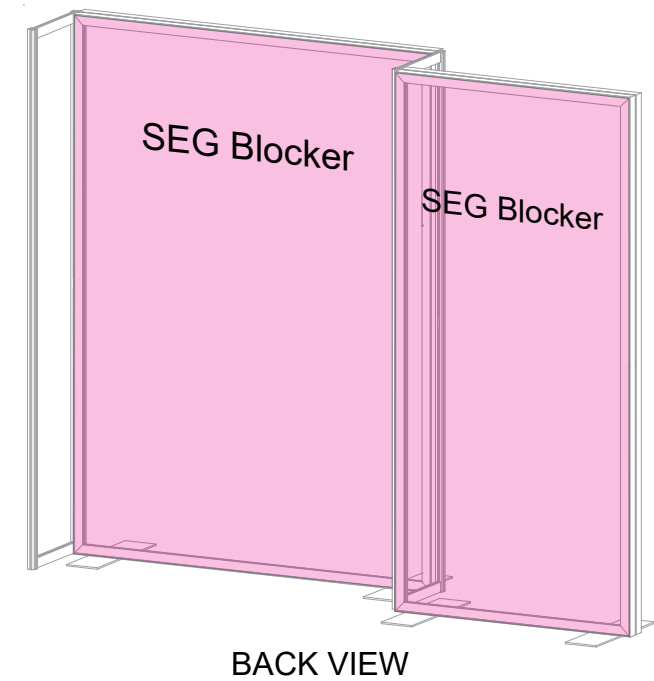
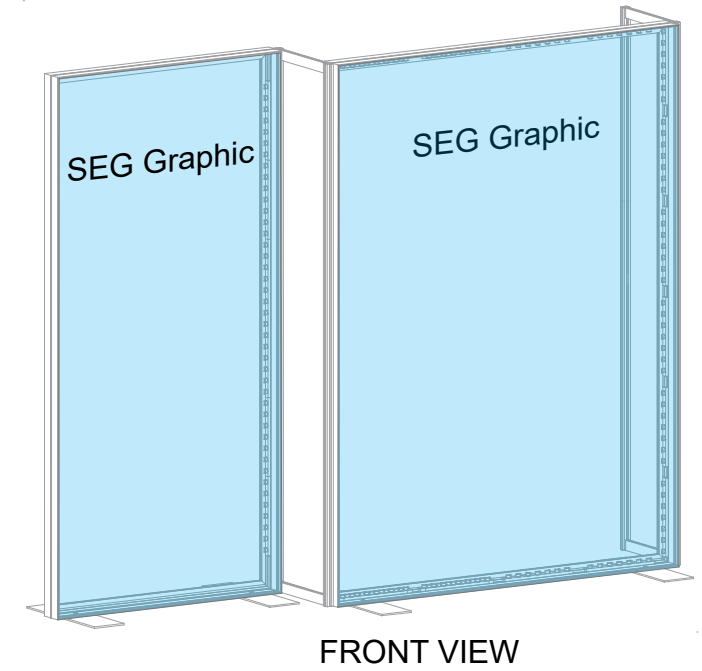
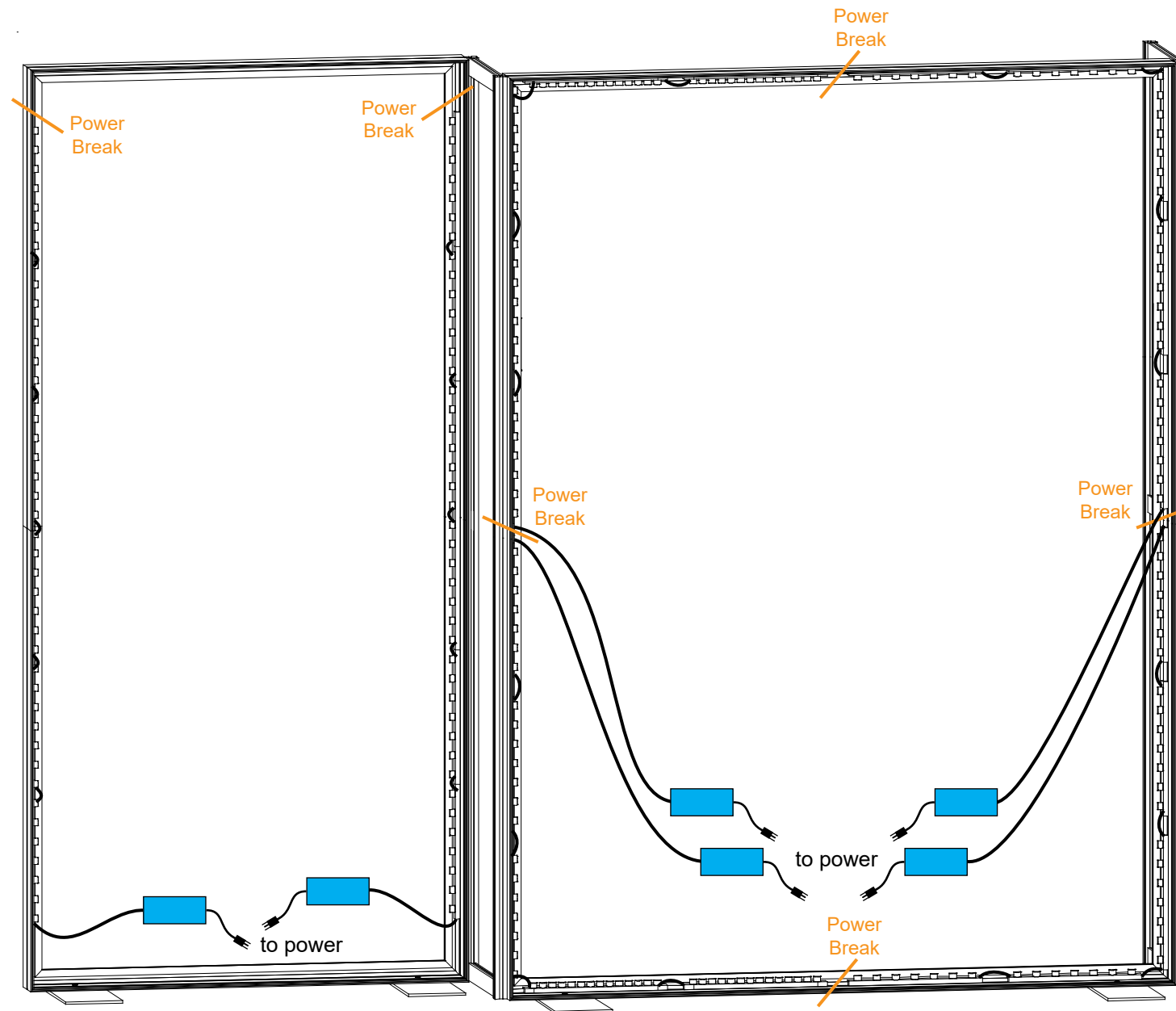
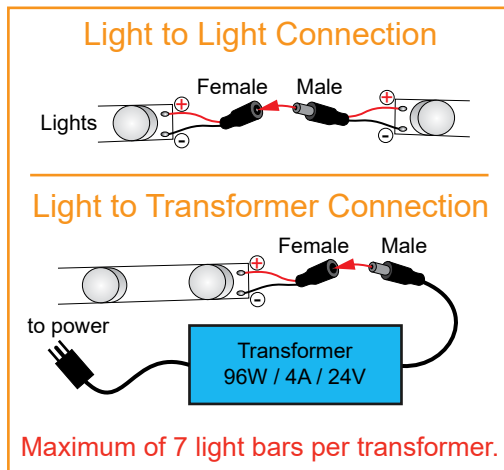

Steps:

- 1) Attach horizontals [1] and [1A] between verticals [2] and [2A], with infill placed into inside grooves. See CEI110 Frame Assembly sheet for instruction.
- 2) Attach horizontal [5] between verticals [2A] and [4], sliding infill into grooves of verticals, then secure with horizontal [5A]. Make sure Velcro is facing inward and at bottom.
- 3) Attach horizontal [6] between verticals [2] and [3], sliding infill into grooves of verticals, then secure with horizontal [6A]. Make sure Velcro is facing inward and at bottom.
- 4) Attach horizontals [7] and [7A] between verticals [3] and [4].
- 5) Connect door to vertical [3]. See [Door Connection](#) detail.
- 6) Connect shelf supports to Velcro on inside of infills, then place shelf on top of supports.
- 7) Connect lights and transformer. See [Light Connection](#) details.
- 8) Install SEG graphic to front of assembled light frame. See SEG Graphic Installation instruction on reverse side.
- 9) Lock counter top to [5A] and [6A]. See [Counter Top Lock](#) detail.

Item	Qty.	Description
1,1A	1,1	22.1654" CEI110 Horizontal Extrusion
2,2A	1,1	38" CEI110 Vertical Extrusion w/ S10
3	1	38" S44 Vertical Extrusion w/ Door Hinges
4	1	38" S44 Vertical Extrusion w/ Door Stop
5,5A	1,1	18" Z45 Horizontal Extrusion
6,6A	1,1	18" Z45 Horizontal Extrusion
7,7A	1,1	18.5" Z45 Horizontal Extrusion

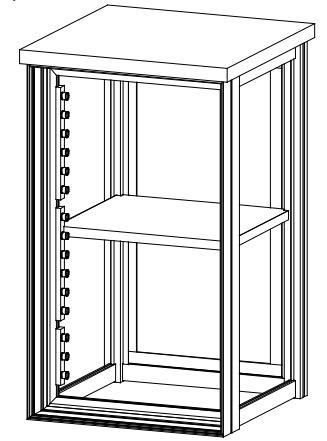

Completed Assembly
(infills not shown)

